



NKBA 2025 Student Design Competition



► COMPETITION CATEGORIES

– Best Concept Kitchen Design

Design a kitchen based on the supplied brief and site plan. If you have already completed Assignment 3, you can adapt your Austin or Reeves project and submit it as your entry for this category.

– Best Installed Kitchen Design

Submit a kitchen design that you have completed for a client from conception to installation (this cannot be a showroom kitchen).

– Best Technical Kitchen Plans

Students who enter Best Concept Kitchen and/or Best Installed Kitchen will automatically be entered into this category. Plans need to meet the NKBA Spatial Design Guidelines and Drawing Standards*.

► HOW TO ENTER

Complete the entry form and email with your entry files (Word, PDF, JPG, JPEG, TIF, TIFF, PNG, PSD, or EPS) to education@nkba.org.nz by **5pm on Friday 28 July**. If your files are too large, please send them via a link.

All files must be clearly labelled with your name and the competition category.

Entry is free!

► WHAT TO INCLUDE

Designs must be presented in A3 landscape format at a scale of 1:20 or 1:25, and include:

- Floor plan
- Elevations
- Renders and/or perspectives
- Mechanical plan (including water, waste, power, and ducting)
- Lighting plan
- Colour scheme/mood board
- Specification sheet

Entries for the Best Installed Kitchen Design category must also include:

- Design Brief outlining the client's requirements (max 150 words)
- Design Statement outlining how you met the client's requirements and overcame any associated challenges (max 350 words)
- 3-5 photos of the completed project
- The name of your photographer.

► JUDGING CRITERIA

The judges will be looking for:

- Designs that meet the client brief
- Plans that are drawn to industry standard*
- Application of spatial design guidelines and design elements/principles
- Creative and cohesive use of colour and lighting

► PRIZES

The winner of each award category will receive a **\$500 cash prize**.

Winners will be notified by Monday 11 August and officially announced at the 2025 Excellence in Design Awards in Auckland on Friday 5 September.



NKBA 2025 Student Design Competition

**Client brief and site plan for entries into the
Best Concept Kitchen Design category.**

Reeves – Kitchen Renovation

► CLIENT BRIEF

- Mature, semi-retired couple
- Adult children no longer living at home
- 1700mm and 1630mm tall
- No disabilities
- Right-handed
- Family home with 3 x bedrooms, 2 x bathrooms, kitchen/living room, and separate lounge
- Kitchen/living room opens to a small north-facing garden with lawn space for grandchildren to play
- The Reeves entertain family members for dinner approximately every 6 weeks, and their grandchildren often stay overnight
- The Reeves want their home to feel comfortable, relaxed, and peaceful, with warm, inviting colours and a modern, minimalistic kitchen
- Budget \$60k, including kitchen cabinetry, benchtops, sink bowl, appliances, and installation
- The Reeves are overwhelmed by choice and would like you to advise them on the options for flooring, cabinetry, wall surfaces, benchtops, and fixtures and fittings that best fit their needs.

► CLIENT WISH LIST

Storage

- Pantry
- Drawers for pots, pans, casserole dishes, baking dishes
- Spice storage near cooktop
- Dedicated small appliance storage
- Wall units, including some with feature glass doors.

Appliances

- Wall oven and microwave or steam oven
- 4-burner electric cooktop (will consider induction) and rangehood
- Integrated dishwasher
- Standard refrigerator/freezer.

Sink and waste solutions

- Waste disposal
- Double waste bins
- Double sink (one large, one smaller), does not mind a draining tray
- Kitchen tap with single lever mixer.

General

- Painted walls and ceilings
- Durable, easy to clean surfaces
- Room for at least three people to eat in the kitchen
- Accent lighting.

– See following page for site plan.



Reeves – Site plan

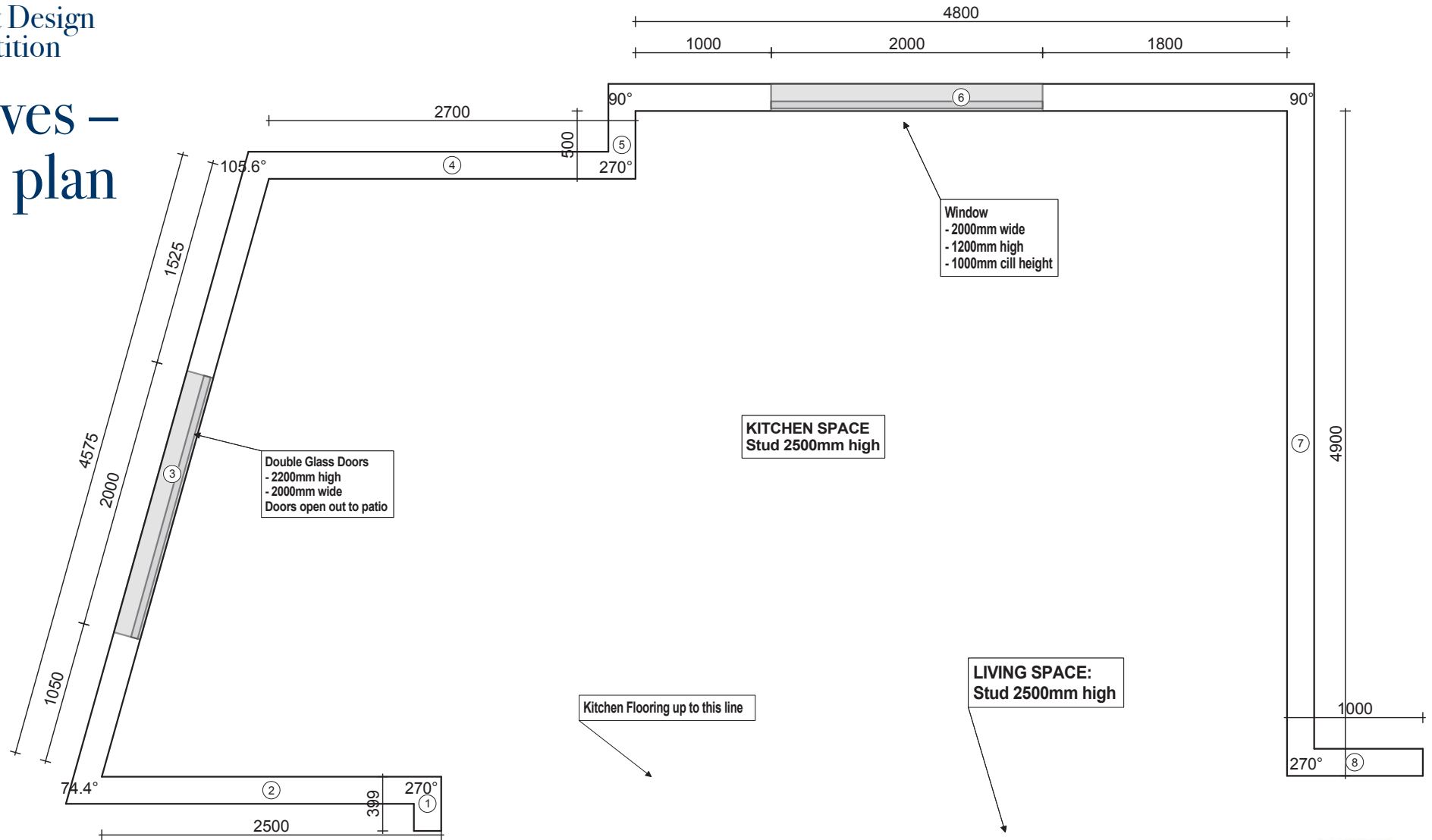



NKBA 2025 Student Design Competition

► TERMS AND CONDITIONS

Entry is free.

Students must be enrolled in the NZ Diploma in Kitchen Design (enrolments currently on 'hold' are not eligible to enter). If you are unsure of your enrolment status, please contact education@nkba.org.nz before submitting your entry.

Students who enter Best Concept Kitchen Design and/or Best Installed Kitchen Design will automatically be entered into the Best Technical Kitchen Plans category.

NKBA and the competition sponsors may profile the winning designers and entries on social media and/or in print publications (with credit to the designer, photographer, employer, and NKBA suppliers, where possible).

The competition is open until Monday 28 July 2025.

*The NKBA Drawing Standards and Spatial Design Guidelines are included in your Year 1 course manual. Email education@nkba.org.nz if you would like a PDF version.

► ENTRY FORM

Name

Contact phone number

Contact email address

I am entering the following categories (please tick):

☐

Best Concept Kitchen Design

☐

Best Installed Kitchen Design

(Entry to Best Technical Kitchen Plans is automatic if entering one or both of the above categories).

Please tick:

☐

I agree to the competition terms and conditions

If entering the Best Installed Kitchen Design category:

☐

My entry is a kitchen in my own home or a family member's home (if applicable)

☐

I confirm that I have permission from my client to enter this competition

☐

I confirm that I have permission from my employer to enter this competition

Signed

Date